

BATCHING SYSTEMS

FLEXIBLE CONFIGURATIONS & COST EFFECTIVE SOLUTIONS

Available with various
mixer, mill, surge tank, and
controller combinations

Let us build you
the perfect system
for your needs.



SMDT-4000 BATCHING SYSTEM - UP TO 11½ TPH CAPACITY

EASY INTEGRATION INTO EXISTING INSTALLATIONS



SMT-2000 SYSTEM -
UP TO 5½ TON/HR. CAPACITY



SM-1000 SYSTEM
UP TO 3½ TON/HR. CAPACITY

FEED BATCHING SYSTEMS



BATCH CONTROLLERS

Windows based batch controller. Multiple scale applications. Harsh environment system shown. Touchscreen available.

**MAKE MORE FEED...FASTER
WITH A COMPLETE FEED BATCHING
SYSTEM FROM SUDENGA INDUSTRIES.**

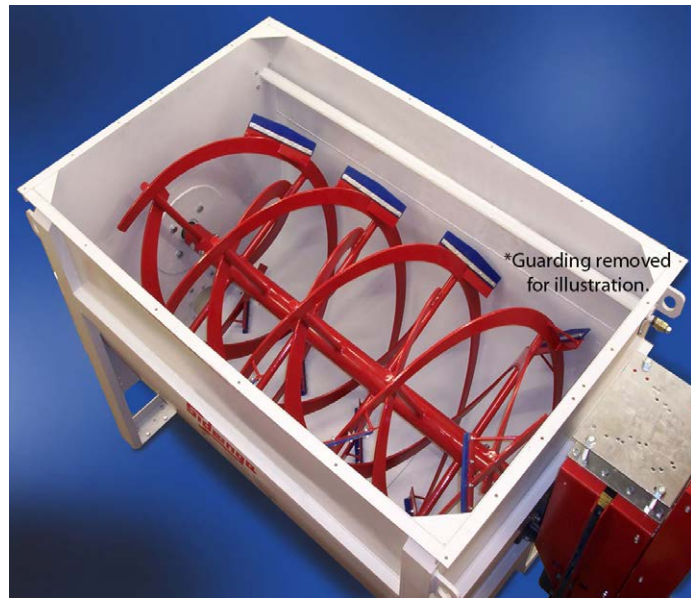

DOUBLE RIBBON MIXERS with capacities to 25 ton/hr.

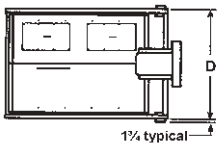

Figure 1 - Mixer

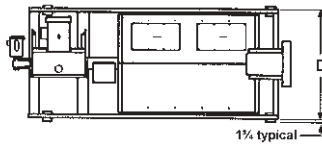

Figure 2 - Mixer-Mill

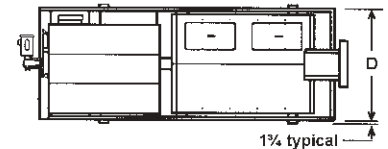

Figure 3 - Mixer-Mill-Surge Tank

Figure	Model	One Mill	Two Mills	Surge Tank	Mixer Capacity	A	B	C	D	E	F
1	S-1000				1000 lb (500kg)	65" (166cm)	67" (170cm)	79" (201cm)	48" (122cm)	--	--
2	SM-1000	x			1000 lb (500kg)	111" (282cm)	67" (170cm)	79" (201cm)	48" (122cm)	54" (138cm)	--
3	SMT-1000	x		x	1000 lb (500kg)	146" (371cm)	67" (170cm)	79" (201cm)	48" (122cm)	54" (138cm)	103" (262cm)
1	S-2000				2000 lb (1000kg)	95" (242cm)	74" (188cm)	90" (229cm)	60" (152cm)	54" (138cm)	--
2	SM-2000	x			2000 lb (1000kg)	148" (376cm)	74" (188cm)	90" (229cm)	60" (152cm)	54" (138cm)	--
2	SMD-2000		x		2000 lb (1000kg)	191" (486cm)	74" (188cm)	90" (229cm)	60" (152cm)	54" (138cm)	--
3	SMT-2000	x		x	2000 lb (1000kg)	177" (450cm)	74" (188cm)	90" (229cm)	60" (152cm)	54" (138cm)	119" (302cm)
3	SMDT-2000		x	x	2000 lb (1000kg)	192" (488cm)	74" (188cm)	90" (229cm)	60" (152cm)	54" (138cm)	123" (312cm)
1	S-4000				4000 lb (2000kg)	145" (369cm)	84" (213cm)	85" (216cm)	60" (152cm)	56" (143cm)	--
2	SM-4000	x			4000 lb (2000kg)	203" (516cm)	84" (213cm)	85" (216cm)	60" (152cm)	56" (143cm)	--
2	SMD-4000		x		4000 lb (2000kg)	238" (605cm)	84" (213cm)	85" (216cm)	60" (152cm)	56" (143cm)	--
3	SMT-4000	x		x	4000 lb (2000kg)	225" (572cm)	84" (213cm)	85" (216cm)	60" (152cm)	56" (143cm)	137" (348cm)
3	SMDT-4000		x	x	4000 lb (2000kg)	239" (608cm)	84" (213cm)	85" (216cm)	60" (152cm)	56" (143cm)	141" (358cm)
1	S-6000				6000 lb (3000kg)	165" (420cm)	105" (267cm)	107" (272cm)	66" (168cm)	--	--



1-888-SUDENGA | 1-712-475-3301 | Fax: 1-712-475-3320
 PO Box 8, 2002 Kingbird Ave., George, IA 51237 USA
 sales@sudenga.com | www.sudenga.com